



ELYPSO



THE VERSATILE FRONT-DESK CARD SYSTEM

The Elypso printer was designed for all your individual plastic card printing and personalization needs: monochrome or color, with multiple encoding options.

Specially developed for use at customer-facing counters, Elypso fits seamlessly with your existing systems and is your best choice for instant card personalization.

CONFIGURATION ON DEMAND

- According to your needs, Elypso can print either single or dual sided cards.
- The printer can also be equipped with encoders for magnetic stripe and contact and contactless smart cards.

PERFECT INTEGRATION

- The software architecture of Evolis Premium SDK was designed to make Elypso fit seamlessly with your existing computer systems.
- Very compact (barely bigger than a standard letter size sheet of paper) and quiet, Elypso is discreet and has a small footprint.

EASE OF USE

- Thanks to Elypso's unique front-loading design, insertion and retrieval of cards make it easy to access even in tight spaces.
- With the Evolis Premium Suite® software you can receive notifications and easily control the printer from your computer.

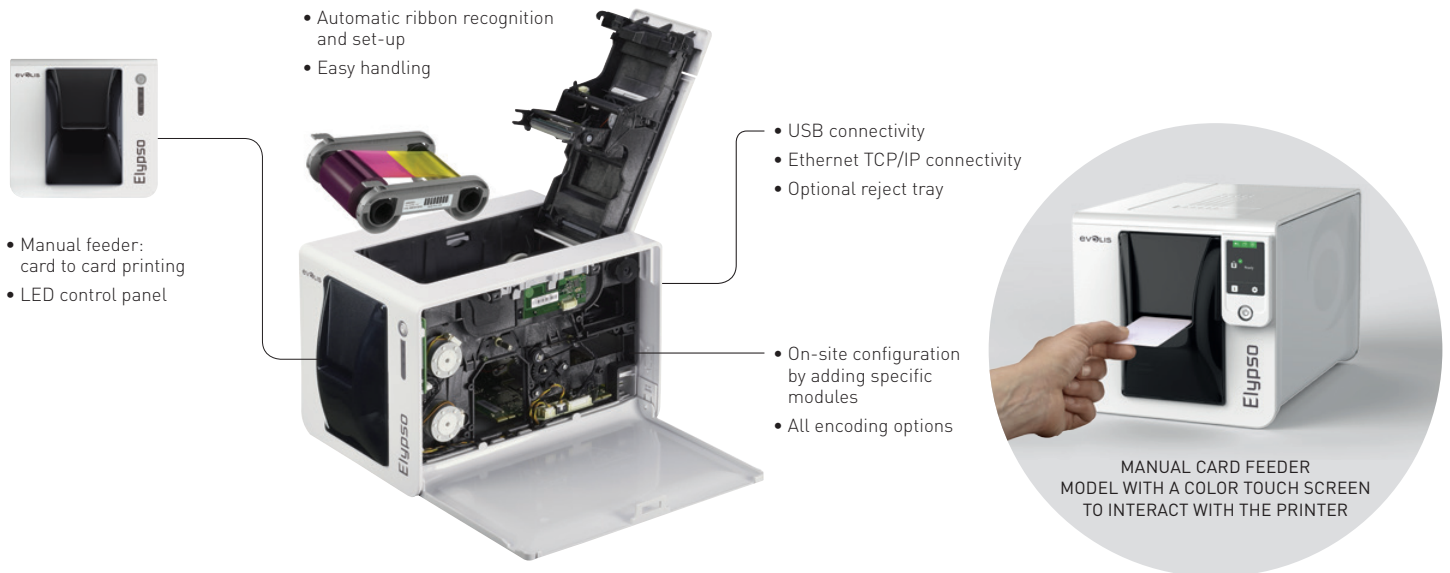

- Automatic ribbon recognition and set-up
- Easy handling
- USB connectivity
- Ethernet TCP/IP connectivity
- Optional reject tray
- Manual feeder: card to card printing
- LED control panel
- On-site configuration by adding specific modules
- All encoding options



MANUAL CARD FEEDER MODEL WITH A COLOR TOUCH SCREEN TO INTERACT WITH THE PRINTER

MAIN FEATURES / Full technical specifications on www.evolis.com

GENERAL FEATURES

- Direct-to-card dye-sublimation/Resin thermal transfer
- Edge-to-edge printing, single-sided, upgrade kit for dual-sided printing as an option
- Standard 300 x 300 dpi resolution
- Customizable 300 x 600 dpi resolution (color and monochrome printing) or 300 x 1200 dpi resolution (monochrome printing only)
- 32 MB memory (RAM) standard - optional 64 MB¹

PRINTING PERFORMANCES

- Single side :
 - Color (YMCKO): 20.2 s per card
 - Monochrome: 6.5 s per card
- Dual side (YMCKO-K): 27.3 s per card

INTERFACES

- USB (1.0, 1.1, 2.0, 3.0), cable supplied
- Ethernet TCP-IP 10BaseT, 100BaseT (Traffic Led)
- 802.11b/g wireless connection as an option

CARD MANAGEMENT AND SPECIFICATIONS

- Manual feeder: card to card printing
- Reject tray: 30 cards (0.76 mm - 30 mil) as an option
- Card thickness: 0.50 to 1.25 mm (20 to 50 mil), no gauge adjustment, case by case for the 0.25 mm/10 mil plastic cards
- Card types: PVC cards, composite PVC cards, PET cards, ABS cards¹, special varnished cards¹
- Card format: ISO CR80 - ISO 7810 (53.98 mm x 85.60 mm)

ADDITIONAL ENCODING MODULES

- Available modules:
 - Magnetic stripe encoder ISO 7811 HiCo/LoCo, JIS2
 - Smart contact station ISO 7816-2
 - Contact smart card encoder - PC/SC, EMV 2000-1
 - Contactless smart card encoder - ISO 14443A, B, ISO15693, MIFARE, DESFire, HID iCLASS, UHF [standard compliance: EPC C1 Gen2 / ISO18000-6C ETSI EN 302 208 or FCC part 15.247]
 - Other specific encoders upon request
- Internal USB or IP ports
- Options can be combined
- Factory-installed or installed on site

SAFETY

- Support for Kensington[®] security lock
- Data encryption for magnetic encoding¹

DISPLAY

- Printer LEDs
- Color touch screen as an option
- Graphical notifications from the printer²: cleaning alerts, empty/low level ribbon alert, etc.

EVOLIS HIGH TRUST[®] RIBBONS

To maximise the quality and durability of printed cards, the lifespan of the print head and the overall printer reliability, use Evolis High Trust[®] ribbons.

- Automatic identification and setting
- Delivered in a drop-in cassette for easy handling
- Ribbon saver for monochrome printing

List of ribbons available on www.evolis.com

SOFTWARE

- Delivered with Evolis Premium Suite[®] for Windows[®]:
 - Printer driver
 - Evolis Print Center for printer administration and settings
 - Evolis Printer Manager for graphical notification³
 - 24/7 online support
 - Compatible with Windows[®] (32/64 bits): XP SP3, Vista, W7, W8, W10
- Delivered with a driver for Mac OS X (from 10.6)
- Linux upon request
- Evolis Premium SDK for remote supervision of the printer, while facilitating and speeding up integration into IT systems

ECO-FRIENDLY DESIGN, CERTIFICATIONS AND STATEMENT OF COMPLIANCE

- Standby, sleep modes & reduced energy consumption
- CE, FCC, ICES, VCCI, CCC, KC, BIS
- EAC⁴
- RoHS

SIZE AND WEIGHT

- Size (H x W x D): 195 x 205 x 314 mm (7.68" x 8.07" x 12.36")
- Weight: 2.95 kg (6.5 lbs)

WARRANTY

- 1-year warranty (printer and print head)⁵
- Warranty extension available as an option

¹ Under specific conditions / ² Depends on the Windows[®] version / ³ Requires the .net 4.0 client profile version
⁴ Depending on the printer model / ⁵ Warranty subject to observance of specific conditions and use of Evolis High Trust[®] ribbons



EUROPE - MIDDLE-EAST - AFRICA

Evolis - 14 avenue de la Fontaine - ZI Angers-Beaucouzé
 49070 Beaucouzé - France
 T +33 (0) 241 367 606 - F +33 (0) 241 367 612 - info@evolis.com

AMERICAS - Evolis Inc. - Fort Lauderdale - evolisinc@evolis.com

ASIA-PACIFIC - Evolis Asia Pte Ltd - Singapore - evoliasia@evolis.com

CHINA - Evolis China - Shanghai - evolischina@evolis.com

INDIA - Evolis India - Mumbai - evolisindia@evolis.com